

# Numatic



Original Instructions

CAUTION. Read instructions before using the machine.

## HZC 390S-2 / HZC 390L-2 1000W (Kit AA16) (Australia)

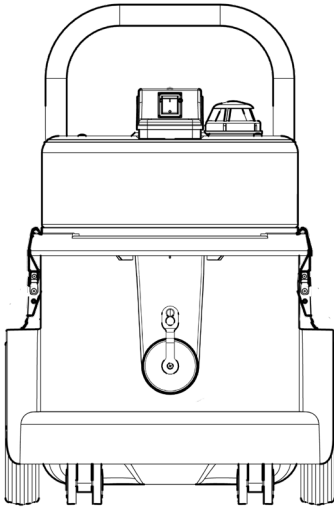

HZC 390S-2

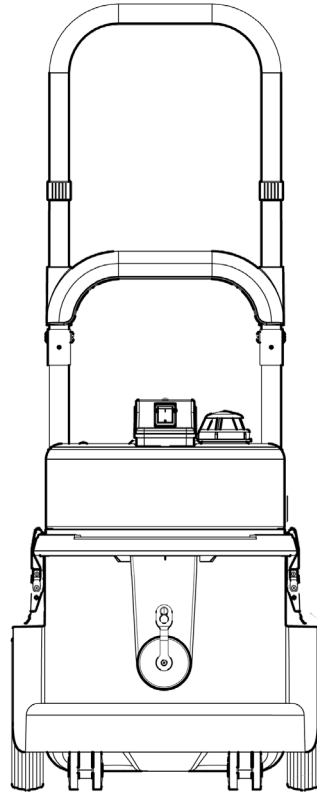

HZC 390L-2

Edgar Edmondson Pty Ltd

Head Office  
PO Box 198  
Marrickville  
NSW 1475  
AUSTRALIA

Delivery and Shipping Address  
18 Garden St  
Marrickville  
NSW 2204  
AUSTRALIA

Office Number: 1800 BUY MOP  
Fax Number: +61 (0)2 9519 9223  
E-Mail: [orders@edmondson.net.au](mailto:orders@edmondson.net.au)  
ABN: 27 000 450 144

# Edco

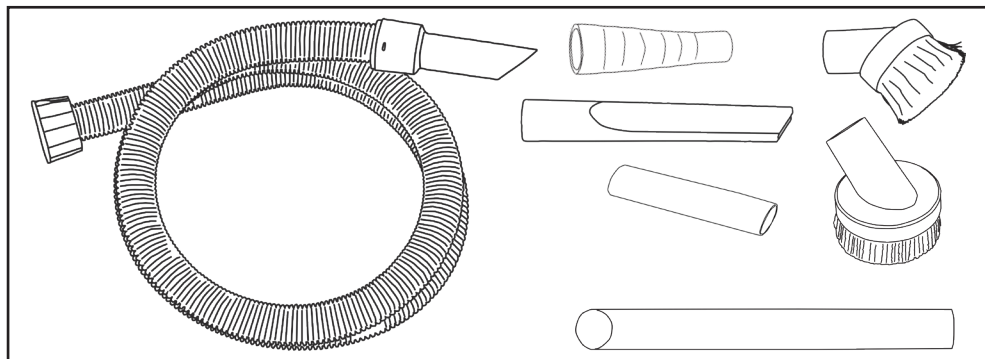

Assembly

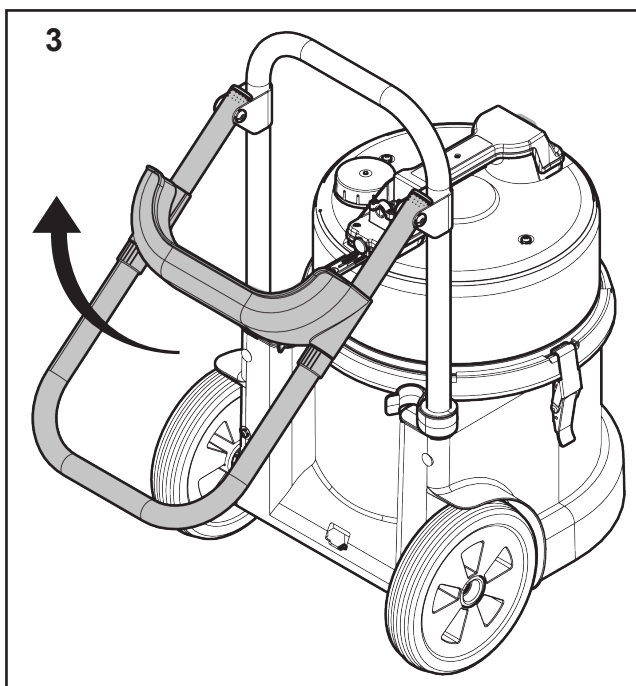
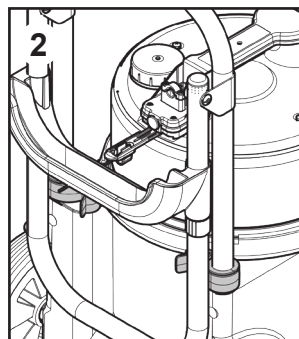
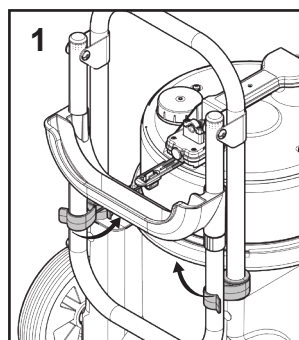

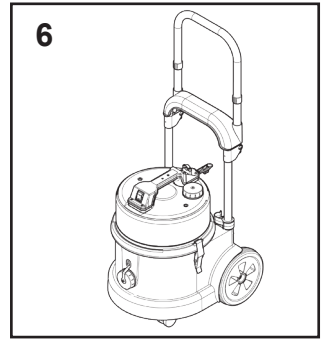
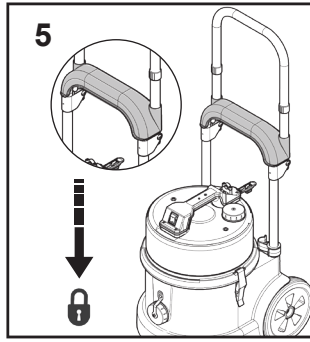
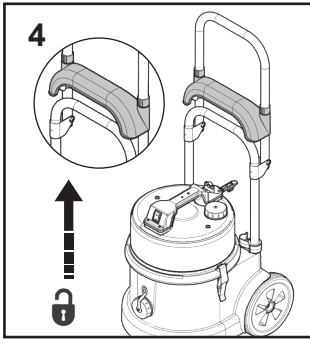

### Air Diffuser

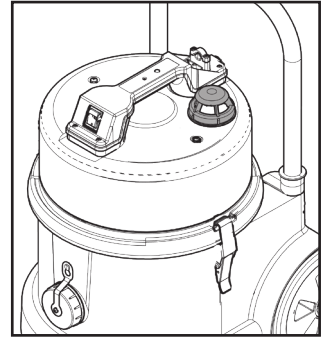
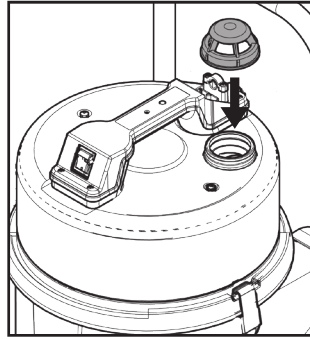
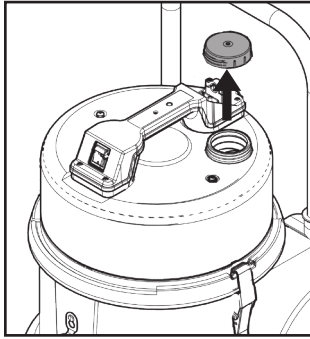

### Hose

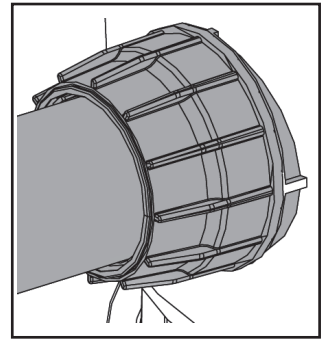
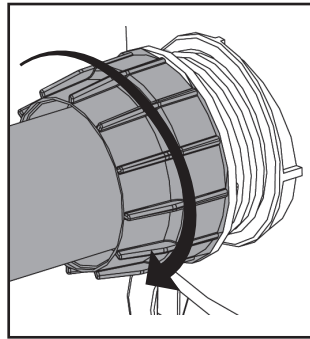
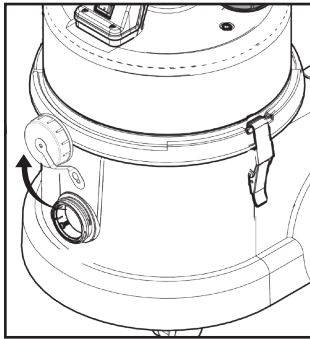

## Using your machine

1  
0

Start
Netzschalter
Démarrage
Start
Ligar
Avvio
Encender
Otwarty

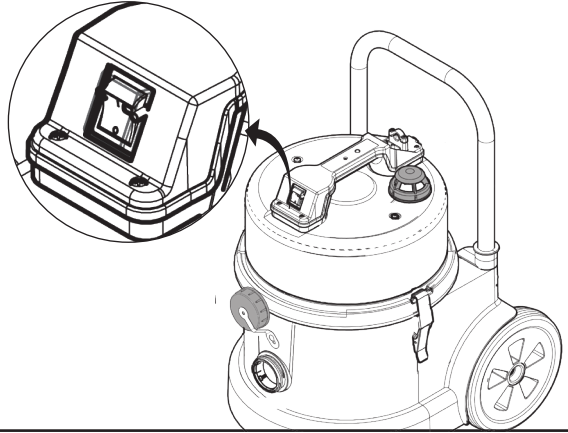

## Moving your Machine

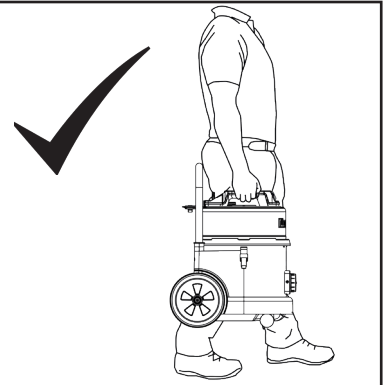
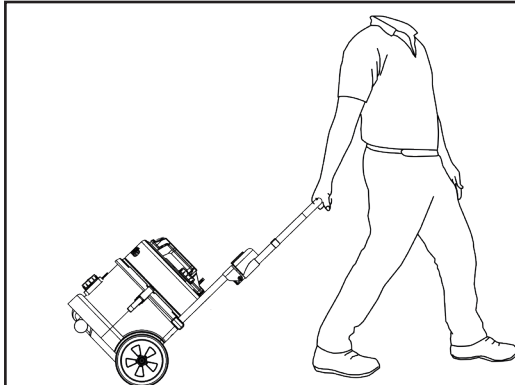
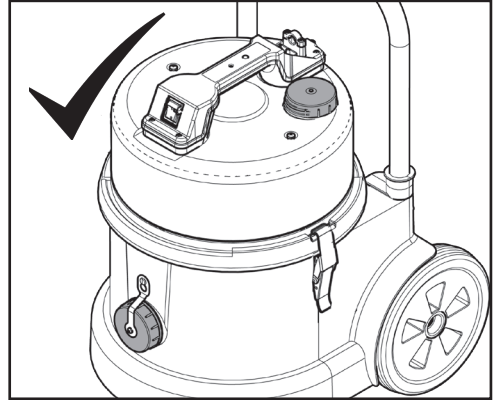
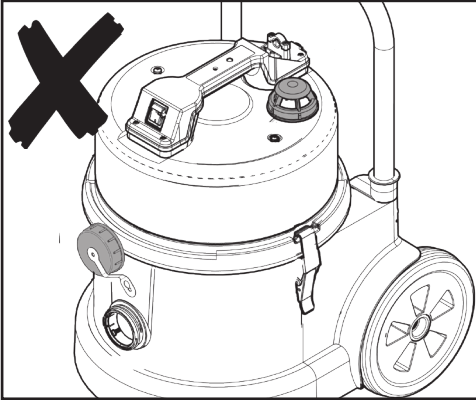

## Replacing the Cartridge Filter

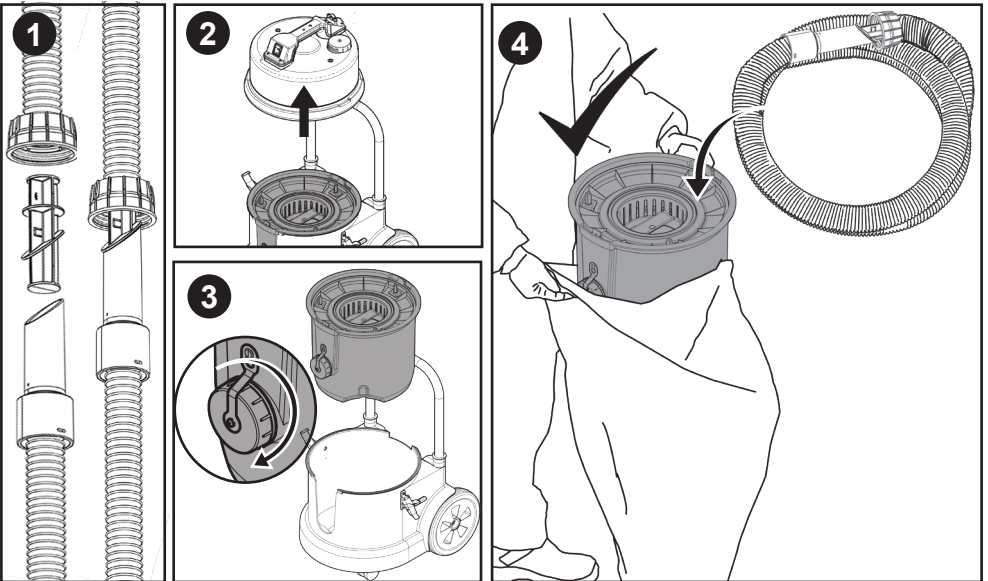
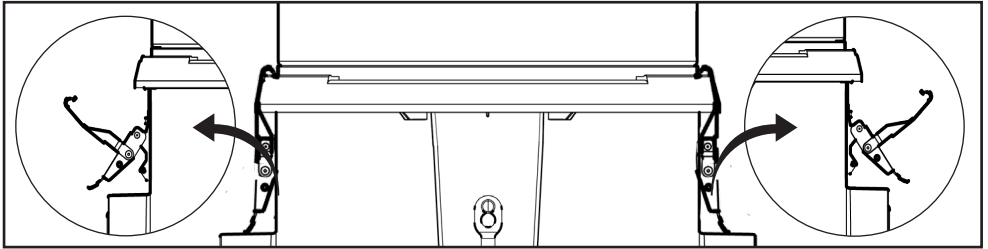

1. Seal contaminated hose using bung supplied.
  - 2/3. Remove the sealed H Class Filter Unit from the drum.
  4. Place the Filter Unit and Hose Assembly inside an impervious plastic bag and seal the bag. Dispose of the plastic bag, depending on contamination, in an appropriate manner.
- Note\* Filter unit is sealed do not attempt to open and reuse.

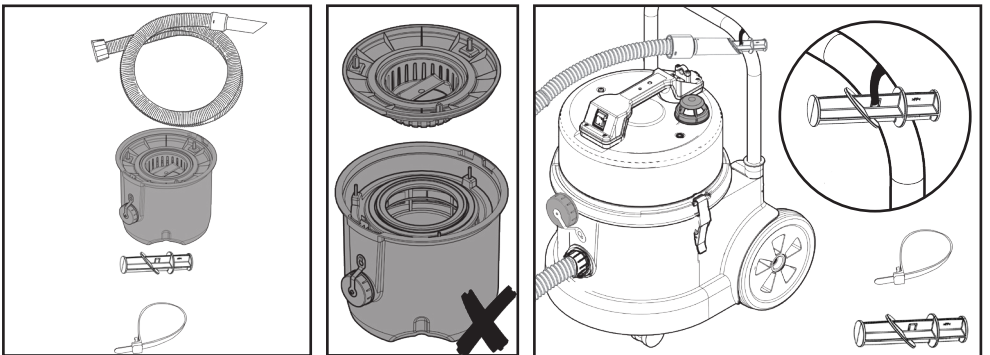



# Changing / Replacing Cable

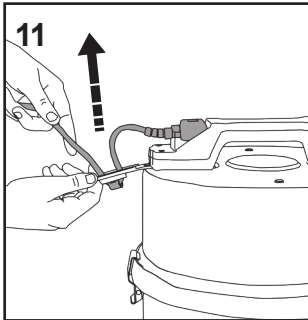
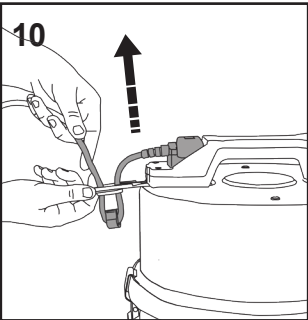
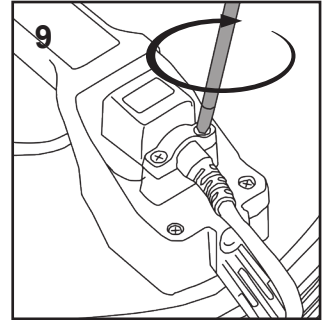
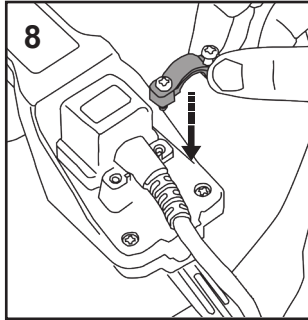
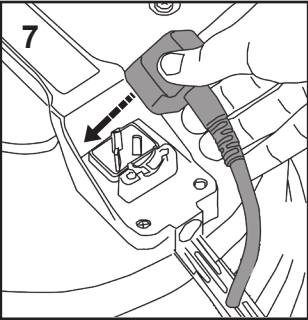
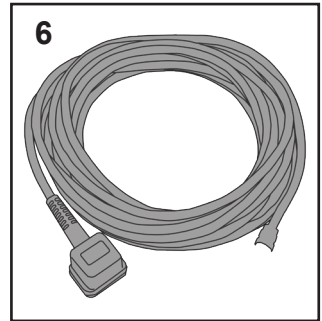
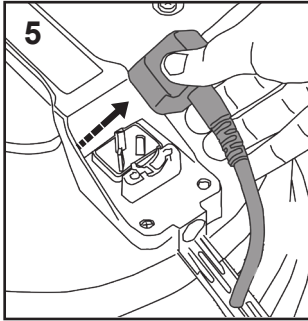
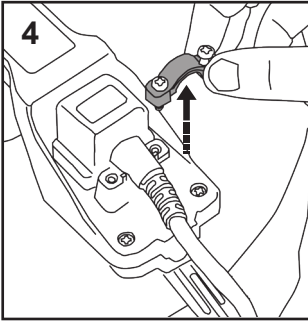
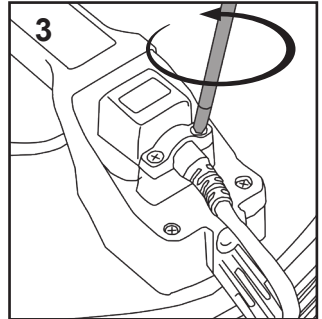
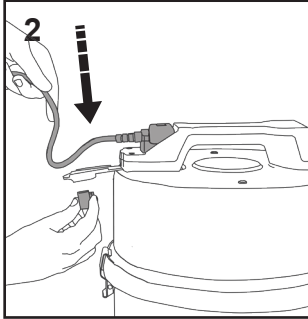
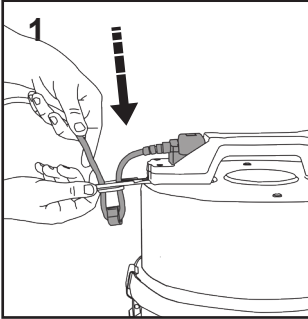



**WARNING**

Read the instruction manual before using the machine.  
Operators shall be adequately instructed on the use of these machines.

As with all electrical equipment, care and attention must be exercised at all times during use, in addition to ensuring that routine and preventative maintenance is carried out periodically to ensure safe operation.

Failure to carry out maintenance as necessary, including the replacement of parts to the correct standard could render this equipment unsafe and the manufacturer can accept no responsibility in this respect.

This machine is for DRY USE only and must not be stored outside or used in wet conditions. The machine shall be disconnected from the mains by removing the plug from the supply socket during cleaning or maintenance and when replacing parts or converting the machine to another function.

This machine is not to be used by children or persons with reduced physical, sensory or mental capabilities, or lack of experience or knowledge.

Children should be supervised to ensure they do not play with the machine  
This machine is not a toy.

Ensure that the filtration system fitted to the machine is suitable for the material being collected.

**CAUTION**

This machine is for use indoors only.  
This machine should be stored indoors only.

**NOTES**

This product complies with the requirements of clause 20 of IEC/EN 60335-2-69 Stability and Mechanical Hazards.

This machine is intended for commercial use, for example in hotels, schools, hospitals, factories, shops, rental businesses and offices for other than normal housekeeping purposes.

**DO**

- Keep your machine clean.
- Keep hoses and tubes clear.
- Replace any worn or damaged parts immediately.
- Regularly examine the power cord. If damage is found such as cracking or ageing the power cord must be replaced by a qualified person using the correct Numatic original part.
- Change 908082 H Class Filter Unit with the correct Numatic approved replacement part.
- Only use the brushes provided with the machine. The use of other brushes may impair safety.
- Only replace the power cord with the correct Numatic approved replacement part.

**DO NOT**

- Unreel the cable with one pull or pull on the cable to unplug the machine from the power supply.
- Use to suck up hot ashes or lighted cigarette ends.
- Use steam cleaners or pressure washers to clean the machine or use in the rain.
- Immerse in water for cleaning.
- Attempt machine maintenance or cleaning unless the power supply plug has been removed from the supply outlet.
- Under any circumstances place foreign objects including (but not limited to) air fresheners, air freshener capsules or scented beads of any type into the top filter of the machine. Doing so can be dangerous and risk damage to the machine and may invalidate the machine warranty.

Before use operators shall be provided with information, instruction and training for the use of the machine and the substances for which it is to be used, including the safe method of disposing of material collected.

The cartridge filter has to be replaced when necessary.

This vacuum cleaner has a lamp that illuminates when air velocity drops below a preset level, which indicates that the cartridge filter must be changed.

This machine is not suitable for connection with dust generating machines.

The cartridge filter must be undamaged and in correct position before this machine can be used safely.

**WARNING:**

1. This machine must only be operated by suitably trained and authorised personnel.
2. This machine or its accessories must not be modified.
3. The machine must not be stored or used in a wet environment.
4. Do not allow the cartridge filter to become so full as to reduce the effective pick-up of the vacuum. (Lamp will illuminate at preset air velocity levels < 20 m/s).
5. This machine must only be repaired by suitably trained and authorised personnel.
6. Only use genuine Numatic International Ltd spare parts, for repairs.
7. This machine must not be installed as a fixed extraction system or run unattended.
8. Do not re-use the essential filter element after removal out of the machine.

Operators should observe any safety regulations appropriate to materials being handled.

This machine is for dry use only.

**PREPARATION FOR USE**

Unpack and identify each item of equipment from the delivery note.

Check that the details given match the information on the "rating plate" mounted on the head assembly.

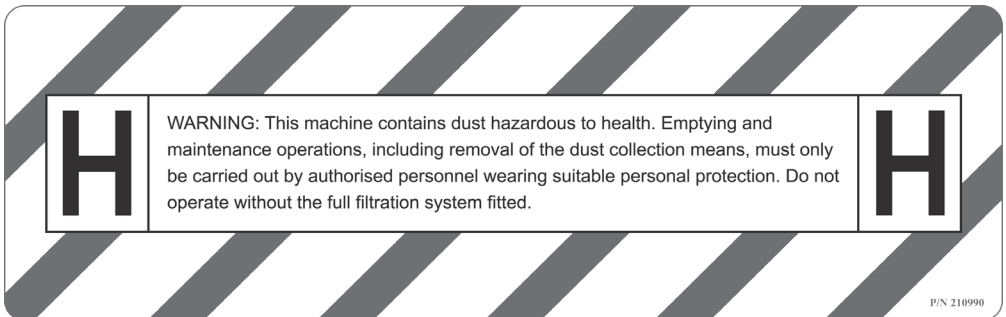

**Installation / Removal / Disposal of the cartridge filter.**

The cartridge filter holding the dust and debris must be removed and renewed by authorised personnel only, wearing appropriate personnel protective equipment, in a specified de-contamination area.

Never operate without the full filtration system in place.

**Process of disposal:**

Disconnect the hose, fit the Dust Cap on the Hose Flange, un-clip the two Toggle Clamps.

Remove the cartridge filter from the Drum. Place the cartridge filter inside an impervious plastic bag and seal the bag.

Dispose of the plastic bag, depending on contamination, in an appropriate manner.

All machine parts should be regarded as contaminated when removed from the hazardous area and appropriate action taken to prevent dust dispersal.

Disconnect from the power supply during cleaning, maintenance or when replacing parts.

Ensure the plug is removed from the socket outlet.

Maintenance must be carried out in a suitable non hazardous area with facilities for cleaning the area after servicing, and with suitable ventilation.

Maintenance and cleaning work must always be carried out by competent authorised personnel equipped with suitable personal protection.

The cartridge filter must be taken out and checked for degree of contamination, and damage to seals.

If the cartridge filter is found to be damaged or badly contaminated, you must replace.

Items that can not be satisfactorily cleaned (e.g. filter) need to be disposed of in an impervious plastic bag and disposed of in accordance with current regulations.

Replace the items that cannot be satisfactorily cleaned using approved manufacturer parts.

Regularly examine the supply cord for damage, such as cracking or ageing. If damage is found, replace the cord before further use.

All parts of this vacuum are safety critical only replace with the genuine Numatic spare parts.

For user servicing, the machine must be dismantled, cleaned and serviced, as far as is reasonably practicable, without causing risk to maintenance staff and others.

Suitable precautions include decontamination before dismantling, provision for local filtered exhaust ventilation where the machine is dismantled, cleaning of the maintenance area and suitable personal protection.

In class H machines the outside of the machine should be decontaminated by vacuum cleaning methods and wiped clean or treated with a sealant before being taken out of the hazardous area and appropriate action taken to prevent dust dispersal. (HSE Risk Assessment needed).

A qualified person must perform at least once a year - or more frequently if national requirements dictate - the filtering efficiency of the filter cartridge must be checked, or the filter cartridge must be replaced, a filter inspection to look for signs of damage, checking the tightness of the machine and correct operation of the control mechanism.

Also the filtration efficiency should be tested at least annually, or more frequently as specified in national requirements.

The test methods that can be used to verify the machine's filter efficiency are specified in EN 60335-2-69 Annex AA (AA22.201.2). If the test fails it should be repeated with a new cartridge filter.

## Replacement parts

909007	H Class Filter Unit (Sealed)
601101	Hose
909221	Sealing Bung
909244	Cable Tie

## Schematic Diagram

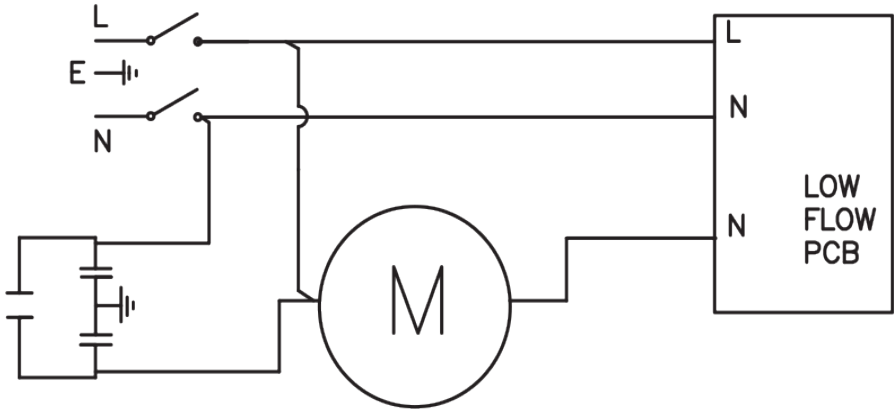

## Data

	1	2	3	4	5	6
HZC 390S-2 HZC 390L-2	13 L	26.8 m	12.2 kg 13.0 kg	LpA ≤ 70 dB (A)	Class I	450 mm x 400 mm x 600 mm 450 mm x 400 mm x 1010 mm

1	2	3	4	5	6
Drum Size	Cleaning Range	Weight (Ready to work)	Sound Pressure	Protection Class	Dimensions



# Warranty

**Numatic International Limited warrant to the original purchaser that its products are free of defects in both material and workmanship for the period shown below:-**

<b>Homecare and Procure Vacuum cleaners.....</b>	<b>2 Years</b>
<b>Rotary Floor Machines.....</b>	<b>1 Year</b>
<b>Twintec Auto Scrubber Dryer.....</b>	<b>1 Year</b>
<b>Vario Ride-On Scrubber Dryer.....</b>	<b>1 Year / 1500 hours</b>
<b>Mopping, Compacts, Versaclean and Versacare Products.....</b>	<b>1 Year</b>
<b>Individual Accessories and Spare Parts.....</b>	<b>6 Months</b>

Note: This warranty expressly excludes consumable parts such as carbon brushes, floor brushes, mops, batteries etc, that are considered replaceable from time to time during the normal working life of the machine.

Our goods come with guarantees that cannot be excluded under the Australian Consumer Law. You are entitled to a replacement or refund for a major failure and for compensation for any other reasonably foreseeable loss or damage. You are also entitled to have the goods repaired or replaced if the goods fail to be of acceptable quality and the failure does not amount to a major failure.

The benefits under (Our Warranty) are in addition to other rights and remedies under a law in relation to the (goods/services)

- A. The warranty period commences from the date the goods are purchased. We advise all purchasers to retain their invoice as proof of purchase.
- B. All warranty claims must be processed through either the Dealer from whom the equipment was originally purchased or another authorised Edgar Edmondson Pty Ltd Australia dealer. The Dealer will co-operate with the purchaser throughout the warranty claims procedure and will arrange any necessary repairs using genuine Numatic parts.
- C. If the original Dealer is no longer able to fulfil his obligations please contact Edgar Edmondson Pty Ltd Australia with full details of the claim and proof of purchase so that this may be processed without delay.
- D. Any warranty claim can only relate to the specific part that is proven to be at fault and for which a replacement will be supplied but cannot be extended to constitute a claim against the complete machine.
- E. Edgar Edmondson Pty Ltd Australia will supply the Dealer with any warranty parts required, subject to the claim being validated.
- F. Claims will not be accepted if they are the result of fair wear and tear, misuse or abuse of any kind.
- G. No replacement will be given unless the appropriate evidence of the validity of the claim has been provided to the satisfaction of Edgar Edmondson Pty Ltd Australia.
- H. Edgar Edmondson Pty Ltd Australia reserve the right to charge for any work carried out as a result of an invalid claim.
- I. No variation to this warranty may be made or implied by any member of Edgar Edmondson Pty Ltd Australia or its Dealers unless such variation is in writing and authorised by the Company.

**Australian Importer.**

Edgar Edmondson Pty Ltd

Head Office      Delivery and Shipping Address  
PO Box 198      18 Garden St  
Marrickville      Marrickville  
NSW 1475      NSW 2204  
AUSTRALIA      AUSTRALIA

Office Number: 1800 BUY MOP  
Fax Number: +61 (0)2 9519 9223  
E-Mail: [orders@edmondson.net.au](mailto:orders@edmondson.net.au)

ABN: 27 000 450 144

# Edco







Distributed by:-

Australian Importer

Edgar Edmondson Pty Ltd

Head Office  
PO Box 198  
Marrickville  
NSW 1475  
AUSTRALIA

Delivery and Shipping Address  
18 Garden St  
Marrickville  
NSW 2204  
AUSTRALIA

Office Number: 1800 BUY MOP  
Fax Number: +61 (0)2 9519 9223  
E-Mail: [orders@edmondson.net.au](mailto:orders@edmondson.net.au)  
ABN: 27 000 450 144

**Edco**



Numatic International Limited.  
Chard, Somerset TA20 2GB ENGLAND  
Tel: 01460 68600 [www.numatic.co.uk](http://www.numatic.co.uk)

Specification subject to change without prior notice  
[www.numatic.co.uk](http://www.numatic.co.uk) © Numatic International Limited

909985 10/21 (A04)